

News

Basel, October 2020

+++ IMPROVEMENTS ON THE CONDAIR OMEGA PRO +++

Dear Business Partners

We are pleased to regularly inform you about technical changes, product details and other helpful information.

We have made numerous improvements to the Omega Pro. These are:

- 1. optimized design of the water cup with splash guard**
- 2. material changeover at the inlet hose**
- 3. change of material for the level control unit from Noryl to Verton**
- 4. design adaptation steam hose nipple**
- 5. color change cylinder insert**

You can find detailed information in the attached PDF file.

Thank you very much for your interest and attention.

Best regards

Sebastian Klein

Technical Product Manager

Direct: +41 55 416 62 39

Mobil: +41 79 743 31 80

sebastian.klein@nordmann-engineering.com

Spencer White

International Business Development Manager

Direct: +41 61 404 46 57

Mobile: +41 76 813 20 28

spencer.white@nordmann-engineering.com

IMPROVEMENTS

CONDAIR OMEGA PRO

Water cup

Optimized design with splash guard

Date: As of calendar week 25/26

Reason: Previous design was more open than required by the regulation, optimized splash water protection in case of pressure shocks. The regulations fulfilled so far are still being observed.

For countries that have changed to the closed Mk5 water cup anyway, nothing changes.

The spare part numbers remain as usual, proactive replacement is not necessary.

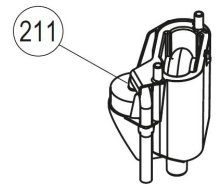
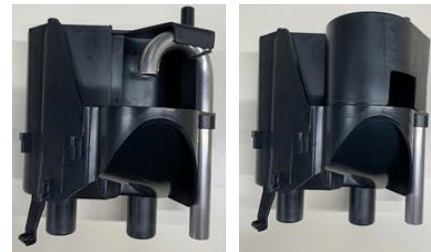

Inlet hose

Material changeover

Date: July 2020

Reason: Improved fit
In the past it was noticed in production that the blue inlet hose on the Omega Pro (212 in the Spare Parts List) had increased tolerances. Since the hose is relatively inflexible, two hose clamps were sometimes necessary to sufficiently seal the connection to the water cup.

For this reason we will change the material to a white, more elastic Aqualife hose. It is identical to the current one in terms of the requirements it meets, but is more flexible, has smaller tolerances and therefore holds better on the metal tube of the water cup.

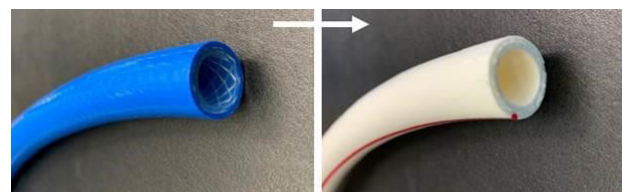
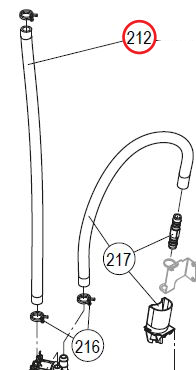
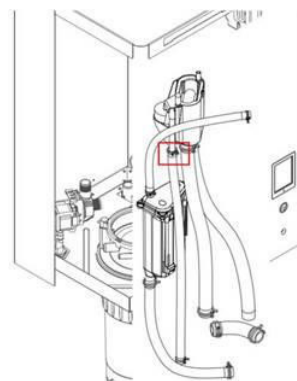

Material: Polyethylene

Temperature Range: -20 / +60 °C

Conformity: DVGW W270
1907/2006/EC
2011/65/EU

The spare part numbers remain as usual, proactive replacement is not necessary.

Level control unit

Material changeover from Noryl to Verton

Date: July/August 2020

Reason: Improved protection against oil residues
Since the SPA segment often works with scented oil, which accumulates on the water surface and has a negative influence on Noryl, we will change the material of the level unit in the coming weeks. The material Verton is characterized by a better resistance to oils and has been used for the Mk5 for years. In the future, the Omega Pro will therefore also have a white level unit.

The spare part numbers remain as usual, proactive replacement is not necessary.

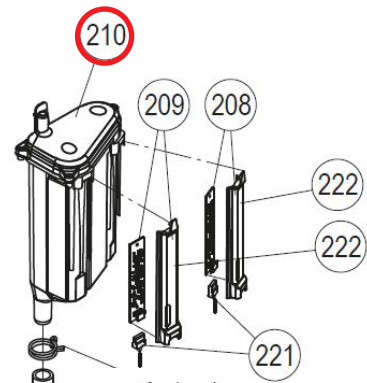

Steam hose nipple

Design adaptation

Date: End of summer 2020

Reason: Optimized pressure compensation, the Venturi effect is minimized and thus the operating stability in critical applications is improved.

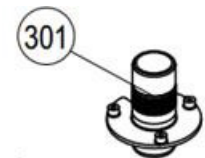

Cylinder insert

Change of colour

Date: If the test is positive, end of summer 2020

Reason: Ecological aspect
Most of the other articles which our supplier produces on his extrusion blow moulding machines are black (typical colour in the automotive industry for technical plastic parts). So far our funnels are in natural colour. Until the extrusion blow moulding line becomes clean after a changeover to our cylinder inserts, they have to scrap pallets of cylinder inserts showing black dots. Therefore we will - if the currently running tests are positive - change the colour of the inserts to black.

The spare part numbers remain as usual, proactive replacement is not necessary.

